

2 REQD. MK. 2C21,2C15

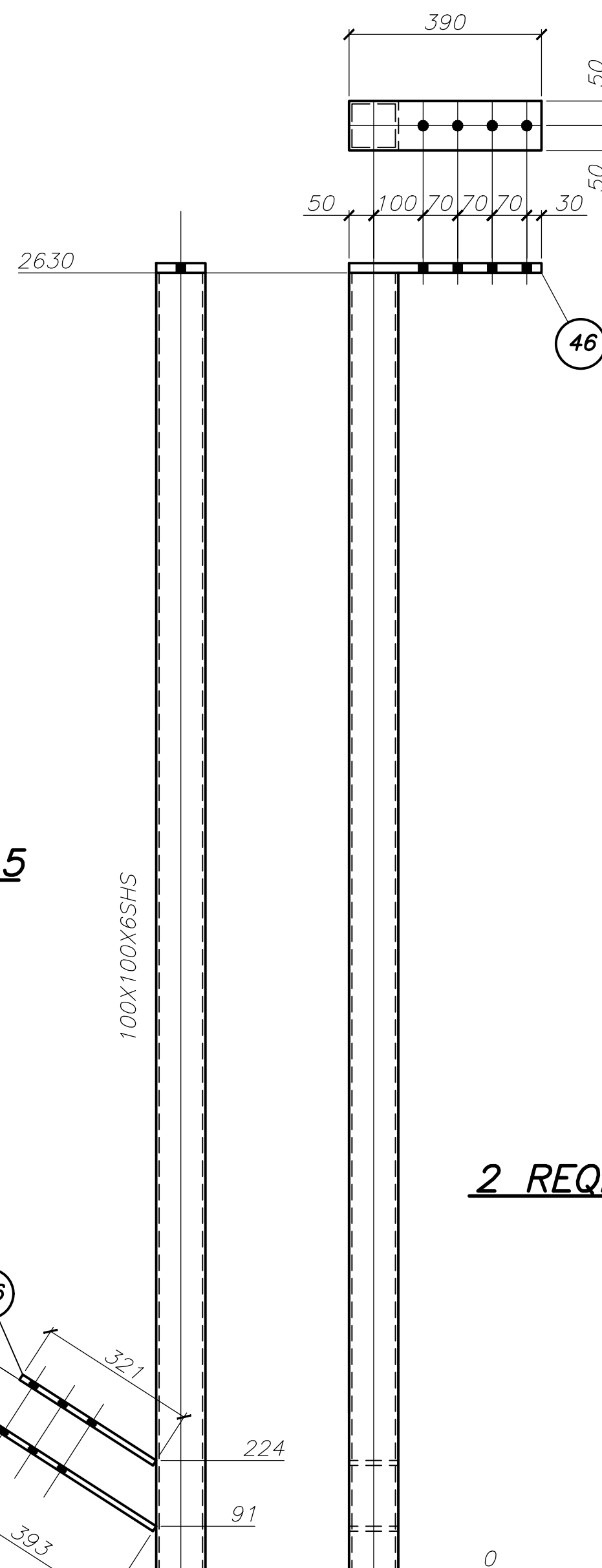

2 REQD. MK. 2C23,2C24

Technical drawing of a vertical structure, likely a chimney or tower, showing dimensions and labels.

The structure is divided into three main sections:

- Top Section:** A rectangular cap with a width of 390 and a height of 50. It features four circular openings. Below the cap, a horizontal section has a width of 50 and a height of 20. The distance from the cap to this section is 50.
- Middle Section:** A long, narrow vertical shaft with a width of 100 and a height of 2930. It is labeled "100X100X6SHS".
- Bottom Section:** A rectangular base with a width of 450 and a height of 50. It features four circular openings. The distance from the middle section to the base is 20.

Dimensions and labels are as follows:

- Top cap width: 390
- Top cap height: 50
- Distance from top cap to middle section: 50
- Middle section width: 100
- Middle section height: 2930
- Middle section label: "100X100X6SHS"
- Distance from middle section to bottom base: 20
- Bottom base width: 450
- Bottom base height: 50
- Labels: 46 (pointing to the top section), 71 (pointing to the bottom base)

1 REQD. MK. 2C40.

STEEL DETAILS